



OUR PRODUCTS

- Waterproofing Products
- Curing Compounds
- Concrete Admixtures
- Grouting Additives
- Epoxy & PU Injections
- Concrete Repairs
- Epoxy & Polyurethane Injection Products
- Flooring Systems
- Civil & Pavement Sealants
- Tile & Stone Adhesives
- Ancillary Products

ABOUT US

Zypexx Biotech India Pvt Ltd is an ISO 14001 : 2015 certified company that develops, manufactures & quality construction chemicals, as well as providing engineering services to protect and enhance civil infrastructures. By providing high-quality construction chemicals, we are well-positioned to meet the growing needs of the construction chemical industry. Assurance of Quality, Integrity & Best Services.

WHY CHOOSE US

On- Time Delivery
Excellent Customer Service

TECHNOLOGY FOR SUSTAINABLE CONSTRUCTION



 **HEAD OFFICE:**

ZYPEXX BIOTECH INDIA PRIVATE LIMITED

C -171, L.G.F - 06, Sector – 63, Noida, 201301 Dist: Gautam Buddha Nagar, U.P

Mob: 91+ 9975768660 | Email: info@zypexx.com | www.zypexx.com

COMPANY PROFILE

ABOUT US : WHO WE ARE

We at Zypexx Biotech India Private Limited high-quality construction chemicals & offer specialist engineering services to protect and enhance civil structures. One of our key strengths is our ability to provide high-quality construction chemicals at competitive prices, which allows us to meet the growing needs of the construction chemical industry. As a company, we pride ourselves on providing quality services, maintaining integrity & dedicating ourselves to excellence.

Besides our own manufacturing facility in Make in India, we have supply networks in all over India. We source our raw materials from around the world & our R & D department is constantly developing new products to meet current technical requirements. We ensure that all of our products comply with international standards including DIN, ASTM, BS many others.

MISSION & VISION

Our mission is to provide our esteemed customers with expert technical advice and high quality products tailored to meet their specific requirements. As part of our mission, we strive to work with integrity, to adhere to industry standards, and to provide the customer with a complete solution, consultation, and appropriate products and Providing clients with a one-stop solution for all of their challenging construction needs is our long-term vision.

PEOPLE BEHIND ZYPEXX

The family here at Zypexx Biotech is a unique one. People with different personalities, backgrounds, talents & abilities have all been drawn together out of curiosity and the need to be challenged by a relevant problem every day. To collaborate and create solutions with minds that think on different tracks. This drive and ambition has brought us all together, each with our own views, creating a synergy that produces innovative solutions to challenging problems.



WATERPROOFING SOLUTIONS



Terrace / Podium / Balconies

Cementitious/ Admixtures
SBR Polymer
Insulation
PU coating/ Spray apply polymer
SBS Membrane

Foundation & Basement

Cementitious/ Admixtures
HDPE & SBS mebrane
Fastplug in
Polyurethane/polyurea
Drainage Board

Bathroom

Cementitious
SBR Polymer
PU coating

Swimming

Admixtures
SBR Polymer
PU / Epoxy
PU Sealant

Floor & Wall

SBS Membrane
Drainage Board
Polyurethane/Polyurea
Mortar
PU Sealant

Roof Garden

Polyurethane
Geo Textile
Drainage Board
Admixture

Grout & Repair

Fast Plug In
Admixtures
Cementitious
Mortar
PU Foam
Epoxy Grouting



WATER PROOFING PRODUCTS



HDPE MEMBRANE

ZYPEXX CONCRETE BOND

Pre - Applied Fully Bonded Sand Faced HDPE Membrane

Zypexx Concrete Bond is pre - applied fully bonded sand faced HDPE waterproofing membrane composed of multi - layer composite that effectively forms a complete and permanent bond & seal with freshly poured concrete against it for unparalleled performance.



ZYPEXX - CONCRETE BOND W2.5

Pre - Applied Sand Coated HDPE Membrane with Heat Weldable Selvage

Zypexx - Concrete Bond W2.5 is pre applied fully bonded HDPE waterproofing membrane composed of multi layer composite with heat weldable selvage (at side laps) that effectively forms a complete and permanent bond & seal with fresh poured concrete against for unparalleled performance.



ZYPEXX-PERFIX DUAL BOND

Pre - Applied Fully Bonded Polypropylene Faced HDPE Membrane

Zypexx-Prefix Dual Bond Pre-applied fully bonded Polypropylene faced HDPE membrane, it prevents movement during the concrete pour. The polypropylene membrane has excellent chemical resistance, it can be used to ensure a good filter velocity and flux. While polypropylene has better resistance to elevated temperatures.



SBS MEMBRANE

ZYPEXX – SUPER BOND

Self adhesive SBS membrane

Zypexx – Super Bond is a self-adhesive bituminous waterproofing sheet with non-protected surface. Composed of self-adhesive SBS polymer bitumen with an upper surface finish of a cross laminated high density polyethylene film (HDPE) and a lower surface finish of siliconized release film.



WATER PROOFING PRODUCTS



PU COATING

ZYPEXX - ZYFLEX PU – 400

1K Aqua Based Polyurethane Elastomeric Waterproofing Coating Zypexx

Zyflex PU 400 is ready to use single component, high solid water borne and U.V resistant pure polyurethane based cold applied elastomeric waterproofing liquid membrane coating.



ZYPEXX - ZYFLEX PU -750

1K Moisture Cured Polyurethane Elastomeric Waterproofing Coating Zypexx

Zyflex PU 750 is ready to use single component, high solid, high tensile and high elongation moisture cured modified polyurethane based cold applied elastomeric waterproofing



ZYPEXX – ZYFLEX 2K PU

2K Polyurethane fast setting self-levelling high textile waterproofing membrane.

ZYPEXX – ZYFLEX 2K SUPER is a PU based Liquid applied double component elastomeric waterproofing membrane Zypexx – Zyflex 2k Super used to provide a continuous, seamless, water and vapour proof membrane for concrete. Typical applications will include roofs, podiums, balconies, floor slabs, suspended floors, patios, bathrooms, inspection pits, swimming pools, bridge decks.



ZYPEXX – ZYFLEX 1000

Fast setting, hybrid polyurea/polyurethane elastomeric waterproof coating.

Zypexx – Zyflex 1000 is a spray-applied, 100% solids, flexible, two-component, rapid curing hybrid Polyurea system, designed as a waterproofing and protective coating. It combines the advantages of seamless coating with long life cycles and high durability.



WATER PROOFING PRODUCTS



PU SEALANT

ZYPEXX - ZYPOX W

Gun Grade

This sealant is renowned for its ability to create robust, long-lasting seals that are resistant to moisture, temperature fluctuations, and environmental stressors. Polyurethane sealants are valued for their ability to bond to a variety of substrates, including concrete, wood, metal, and plastics, making them a versatile choice for a range of sealing and bonding applications.



ZYPEXX- ZYCOSEAL TPU

Pour Grade

Zypexx-ZycoSeal is a multi-component joint sealant, based on a liquid polysulphide polymer which when mixed and applied, cures to form a tough, rubber-like seal. The cured sealant exhibits excellent adhesion to most primed surfaces including concrete, aluminium and stainless steel. Sealing horizontal movement joints in building and civil engineering structures, including roads, floors, airfields and subways.



CEMENTITIOUS ELASTOMERIC WATERPROOFING

ZYPEXX – ZYCRETE SUPER

2K Elastomeric Cementitious Waterproofing Coating

2K Elastomeric Cementitious Waterproofing Coating. Zypexx – Zycrete Super you get on elastomeric acrylic emulsion combined with cementitious powder, proprietary activating chemicals & high grade quality aggregate fillers with selected bonding agents. Water repellency against dampness & ground water as well as hydrostatic pressure is provided by Zypexx – Zycrete Super. It can simply be applied with a stiff brush, roller or trowel to obtain the desired thickness.



ZYPEXX – ZYCRETE SUPER PLUS

2K High Performance Polymer Modified Flexible

Cementitious Protective & Waterproof Coating Membrane

2K High Performance Polymer Modified Flexible Cementitious Protective & Waterproof Coating Membrane. Zypexx – Zycrete Super Plus 2K is an elastomeric polymer cementitious modified waterproofing system with 220% elongation property featuring high – quality cement, carefully selected fillers, and additives. The Zypexx – Zycrete Super Plus 2K remains flexible under permanent immersion and when exposed to the external environment. The product is ideal for waterproofing pools, water tanks, reservoirs, and masonry and concrete structures.



WATER PROOFING PRODUCTS



POLYMER WATERPROOFING COATING

ZYPEXX – ZYCRETE SBR POLYMER

Single Component Acrylic Polymer Waterproofing System

Zypexx – Zycrete SBR Polymer is an acrylic polymer waterproofing system for protecting concrete & masonry surfaces. In conjunction with cement Zypexx – Zycrete SBR provides a seamless waterproof coating to concrete and masonry surfaces. It can be used as a waterproof or protective coating. Zypexx- Zycrete SBR can be used for following application : concrete structures like sunken portion, toilets, balcony, basement, chajjahs, terrace, concrete repairs.



INSULATION

ZYPEXX – ZYCOFOAM 50

Sprayable Polyurethane Foam for Puff Insulation

Zypexx – Zycfoam 50 is Polyurethane based, two component HFC blown, free from CFC/HCFC sprayable rigid closed-cell foam system for the insulation of roofs. Particularly suitable for coating system for a combination of waterproof and fire-rated insulation system for roofs.



ZYPEXX – ZYPTO KOTE

Thermoguard Sheet For Thermal Insulation.

Zypexx-Zypyto kote thermal insulation refers to materials or techniques used to reduce the transfer of heat between two surfaces or areas of different temperatures. It is used to maintain a comfortable indoor temperature in buildings, to prevent heat loss from pipes and equipment and to protect against extreme temperatures in industrial processes.

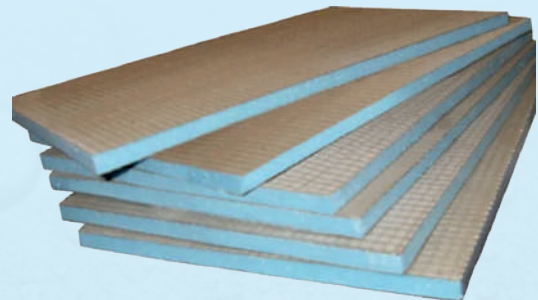

PRIMER

ZYPEXX - ZYCO PRIME

Primer for 2 component PU/Polyurea

Zypexx Zycoprime is a high-quality primer designed to improve the adhesion of coatings and membranes to various substrates. It ensures a strong bond, enhancing the performance and durability of subsequent layers. Zycoprime is easy to apply and dries quickly, providing a reliable base for your coatings. It is suitable for use on concrete, masonry, and other surfaces, ensuring consistent and dependable results.



WATER PROOFING PRODUCTS



ZYPEXX - ZYCOPRIME PLUS

Primer For Roof Insulation.

For enhanced priming performance, Zypexx Zycoprime Plus offers superior adhesion and durability. This advanced primer ensures a strong bond between substrates and coatings, enhancing the longevity and effectiveness of your waterproofing or protective systems. Zycoprime Plus is easy to apply and works well with a variety of surfaces, providing a reliable foundation for your coatings. It ensures optimal performance and protection.



EPOXY COATING

ZYPEXX - ZYCOFOIL EFG

Food Grade Epoxy Coating.

Zycofoil EFG is a food grade epoxy are specialized type of epoxy resin that is safe for contact with food and drinking water. It's commonly used to coat and line potable water tanks. This epoxy creates a protective barrier that prevents impurities and harmful substances from contaminating the water.



ZYPEXX - ZYCO BIT BTM

Bitumen Based Epoxy Coating.

Zyco bit BTM referred to as epoxy-modified bitumen, is a hybrid material that blends the flexibility of traditional bitumen with the mechanical strength and durability of epoxy resin. This combination results in a highly resilient material with superior performance compared to conventional bitumen. making it an ideal choice for demanding construction applications such as pavements, bridges, and waterproofing.



ZYPEXX - ZYCO COAT CTC

Non-Toxic Epoxy Coating.

Zypexx - Zyco Coat CTC our chemical resistant floor coating is multi-functional in its ability to protect concrete from exposure to corrosive chemicals and a range of extreme pH materials that would have otherwise damaged other types of floor toppings linings. chemical resistant epoxy flooring systems are seamless, 100% solids, resurfacing systems with High Chemical Resistance.



WATER PROOFING PRODUCTS



CRYSTALLINE WATERPROOFING

ZYPEXX – CRYSTALSEAL B16 ADMIXTURE CRYSTALLINE WATERPROOFING AND DURABILITY ADMIXTURE

ZYPEXX - CRYSTALSEAL B16 ADMIX is a hydrophilic fiber reinforced crystalline admixture powder that interacts with the capillary pore structures in concrete to generate a waterproofing system that is a permanent part of the concrete matrix made of specific cements, carefully controlled silica and special active chemical additives. Once added to the concrete batch ZYPEXX CRYSTALSEAL B16 ADMIX reacts with the fresh concrete and crystallises inside by forming non-soluble particles that blocks the capillarity network of the concrete structure.



ZYPEXX – CRYSTALSEAL SUPER COATING Crystalline Waterproofing Coating

Zypexx – Crystalseal Super Coating is a surface-applied, integral crystalline waterproofing material, which waterproofs and protects concrete in-depth. It consists of Portland cement, specially treated quartz sand and a compound of active chemicals. Zypexx needs only to be mixed with water prior to application.



ZYPEXX – SWELLFIX V Concrete Joint Waterstop

Zypexx – Swellfix V is a unique bentonite infused butyl rubber sealing compound designed to expand rapidly when exposed to moisture, making it a self-healing joint material for construction joint applications.

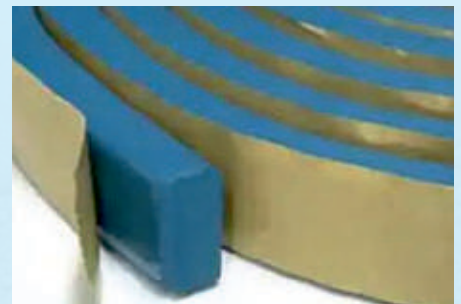

ZYPEXX – CRYSTALCRETE CRYSTALLINE MORTAR Crystalline Waterproofing Mortar

Zypexx – Crystalcrete Mortar consists of Portland cement, specially treated quartz sand and a compound of active chemicals. The active chemicals react with moisture and the by-products of cement hydration to cause a catalytic reaction, which generates an insoluble integral crystalline complex. These crystalline complexes grow in the presence of water and block the capillaries of the concrete and minor shrinkage cracks, thus waterproofing the concrete. Chemical activation begins when the powder is mixed with water and may take several days to completely block the capillaries, depending on ambient temperature and environmental conditions.



WATER PROOFING PRODUCTS



ZYPEXX – CRYSTALSEAL B5 ADMIXTURE

Crystalline Waterproofing & Durability Admixture

Zypexx-Crystalseal B5 is water resistance admixture for cement mixtures B5 SBR Bond, An economical cement bonding agent containing water to strengthen the cohesion properties and improve the mechanical strength of cement mixtures, a rubber based component, worth on and restores aerated concrete internally & externally.



ZYPEXX – CRYSTALSEAL PLUS DRY SHAKE

Crystalline Waterproofing Dry – Shake

Zypexx – Crystalseal Plus is a unique integral crystalline chemical treatment for the waterproofing and protection of concrete. Zypexx – Crystalseal Plus has been specially formulated for dry-shake applications on horizontal concrete surfaces where greater impact and abrasion resistance is required. Packaged in the form of a dry powder compound, Zypexx – Crystalseal Plus consists of Portland cement, various active proprietary chemicals, and a synthetic aggregate hardener that has been crushed and graded to particle sizes suitable for concrete floors.



ZYPEXX – CRYSTAL FAST PLUG

Crystalline Waterproofing Rapid Set Waterplug

Zypexx – Crestal Fast Plug is a rapid setting, integral crystalline cementitious waterstop designed to stop active water leaks and moisture ingress. Crestal Fast Plug can be used internally or externally as a waterproof plugging mortar or where rapid setting and early strength gain is required.



WATER PROOFING PRODUCTS



BASEMENT, RAFF & RETAINING

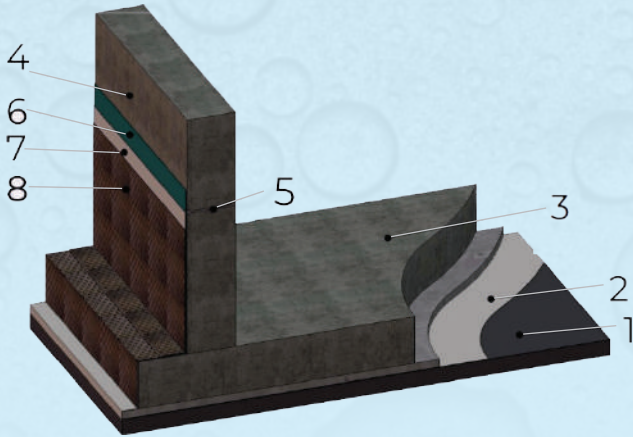

1. PCC
2. HDPE MEMBRANE
3. RAFT
4. RETAINING WALL
5. FILLING CONSTRUCTION JOINTS, CRACKS TIE ROD HOLES AND FLOOR TO WALL JOINTS WITH POLYMER MODIFIED CEMENT MORTAR
6. BITUMEN PRIMER
7. SBS MEMBRANE
8. PROTECTION BOARD

PODIUM & TERRACE

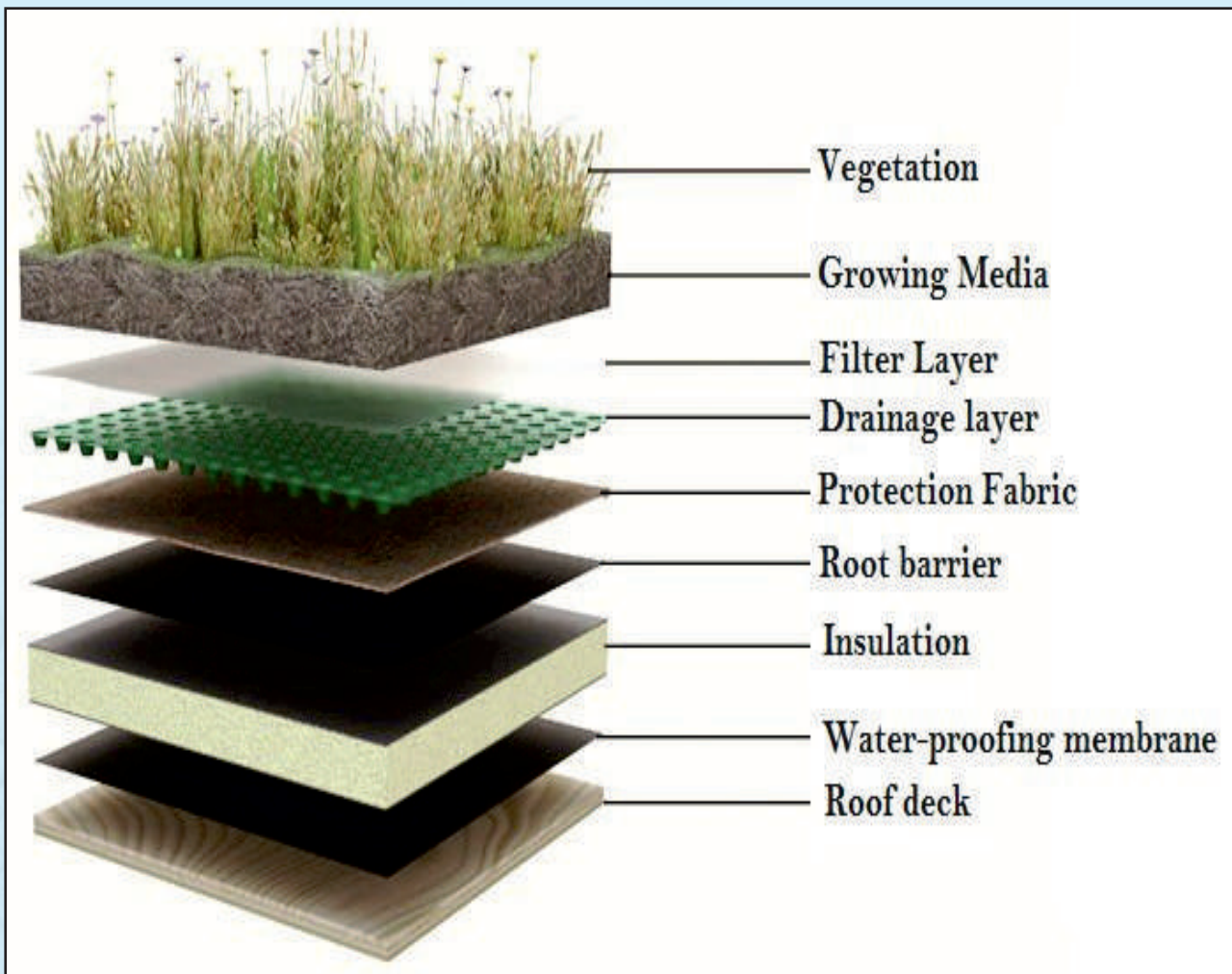

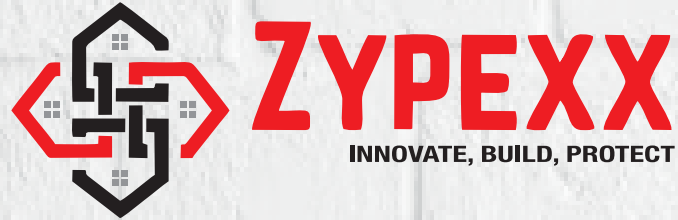

DISCLAIMER: The product information & application details given by the company & its agents has been provided in good faith & meant to serve only as a general guideline during usage. Users are advised to carry out tests & take trials to ensure on the suitability of products meeting their requirement prior to full scale usage of our products. Since the correct identification of the problems, quality of other materials used and the on-site workmanship are factors beyond our control, there are no expressed or implied guarantee/warranty as to the results obtained. The company does not assume any liability or consequential damage for unsatisfactory results, arising from the use of our products.

🏠 HEAD OFFICE:
ZYPEXX BIOTECH INDIA PRIVATE LIMITED

C -171, L.G.F - 06, Sector – 63, Noida, 201301 Dist: Gautam Buddha Nagar, U.P
Mob: 91+ 9975768660 | Email: info@zypexx.com | www.zypexx.com

